

# **INSTALLATION MANUAL i3CONNECT LIFT 4**

# WHAT'S INSIDE THE BOX?

## MOBILE BASE

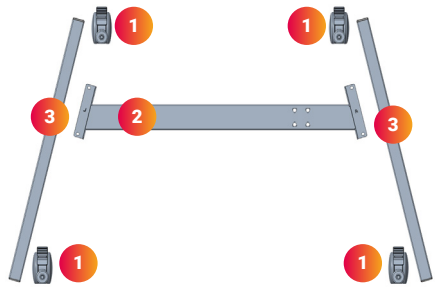
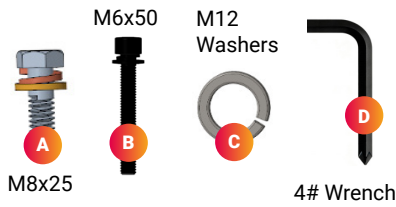

## LAPTOP TRAY

(Optional accessory)

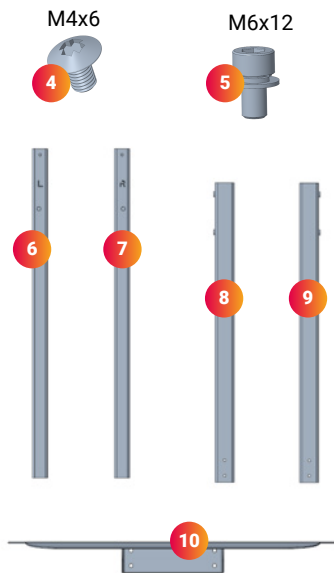

## WALL / COMMON STAND

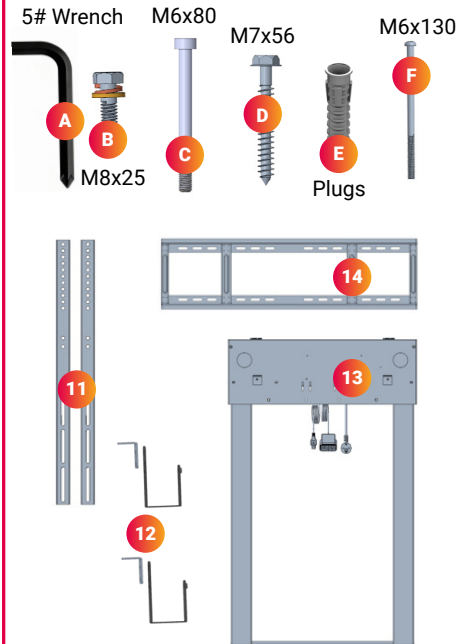

# **BEFORE INSTALLING THE i3CONNECT LIFT 4**

## **Do you want to install the i3CONNECT Lift 4 on a wall?**

Hop over to page 4 to start your installation. Since you will not be installing the wheels, you can skip page 7 to 8 of this manual.

## **Do you want to use the i3CONNECT Lift 4 as a mobile stand?**

You can start you can skip page 4 to 5.

## **Do you want to install the laptop tray?**

You can find the instructions on page 9 - 11.

Please note that the laptop tray is an optional accessory.

## **WARNINGS**

### **Thermal Protection**

Lift 4 has a thermal protection to protect the motors against overheating and degrading over time. When the amount of movement within 2 minutes exceeds a certain threshold, the lift will cool down for 18 minutes to protect the motors.

During these 18 minutes, pressing the up/down buttons will beep to let you know it is cooling down and the lift will not move.

### **Collision detection**

The Lift 4 has collision detection that stops the lift when moving into objects. Note that this detection has a certain threshold to enable smooth movement in normal conditions. Do NOT put fragile objects or body parts under screen.

# INSTALLATION OF THE WALL STAND

## Step 1: install the wall fixing brackets

Unwrap the Allan wrench and install the wall fixing brackets by screwing the m6x80 screws and the m8x25 screws into place. Make sure to secure the screws tightly.

The wall fixing brackets should be installed at an appropriate height, the recommended height is 700-750mm.

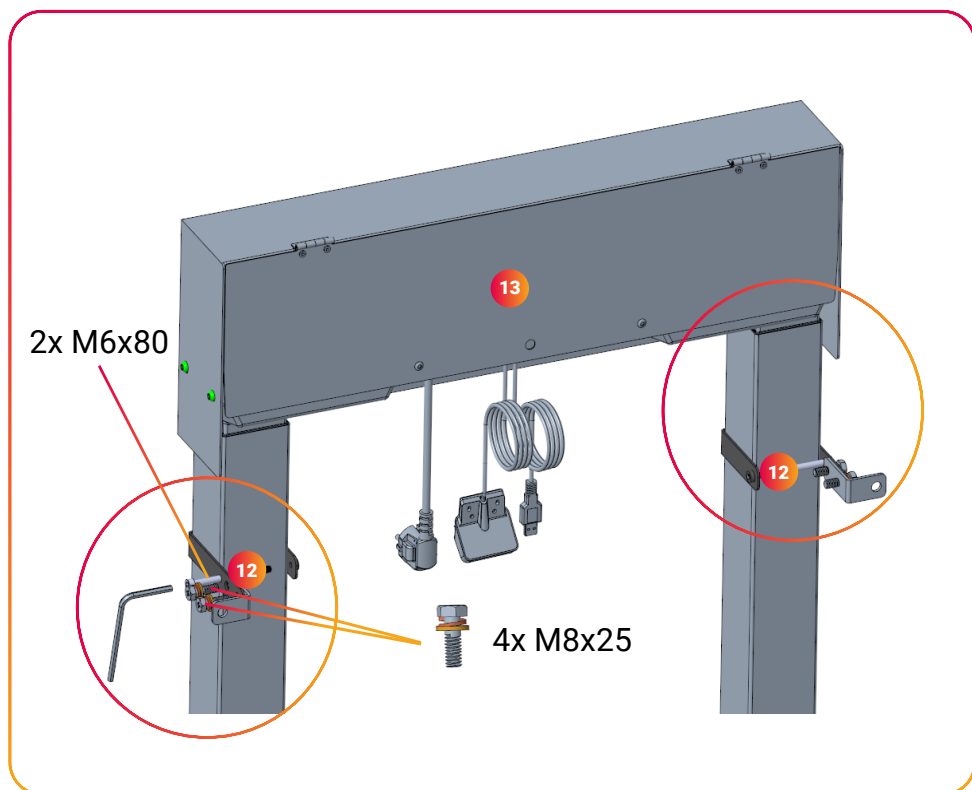

# INSTALLATION OF THE WALL STAND

## Step 2: Drill the holes into the wall

Before fixing the stand onto the wall and the ground, drill 6 holes into your wall at a recommended diameter of 10mm and at a depth of 60mm. Put the expansion rubber plugs into the wall and secure the M7x56 screws tightly.

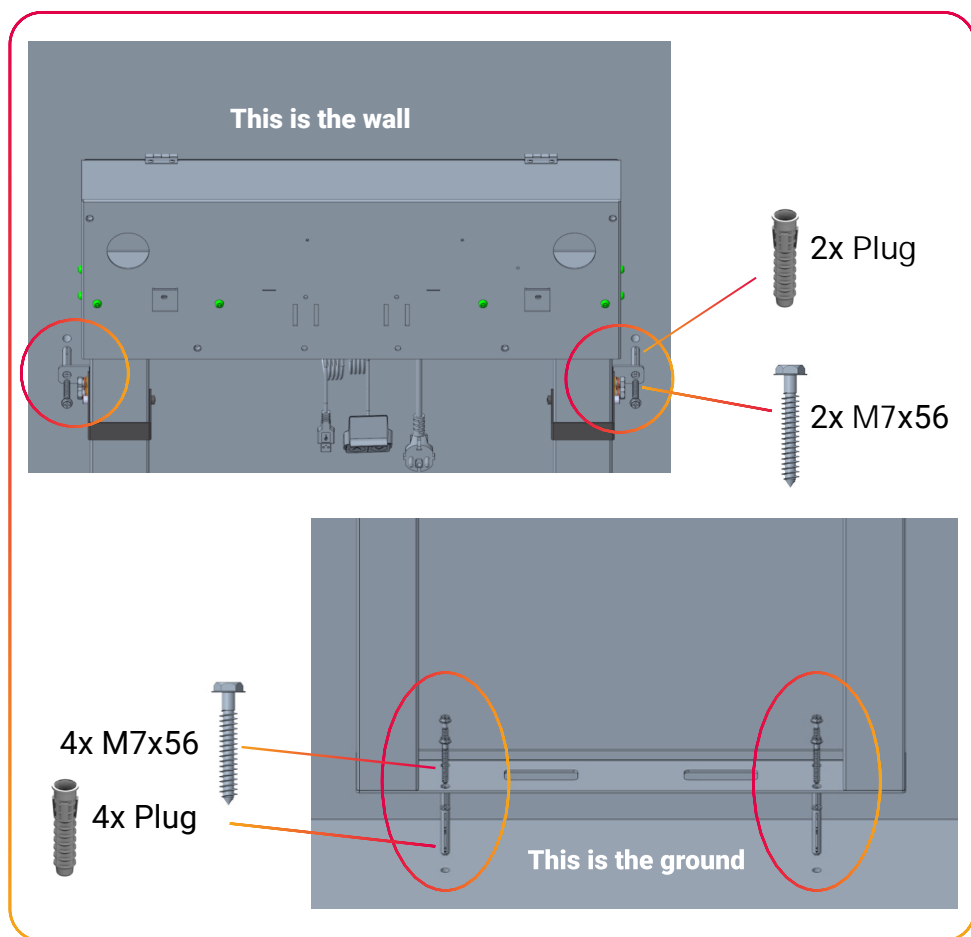

# INSTALLATION OF THE WALL STAND

## Step 3: Attach the wall fixing bracket

You can now attach part 14 (which is the wall fixing bracket) onto the base of the stand with M8x25 screws. Make sure to properly tighten the screws.

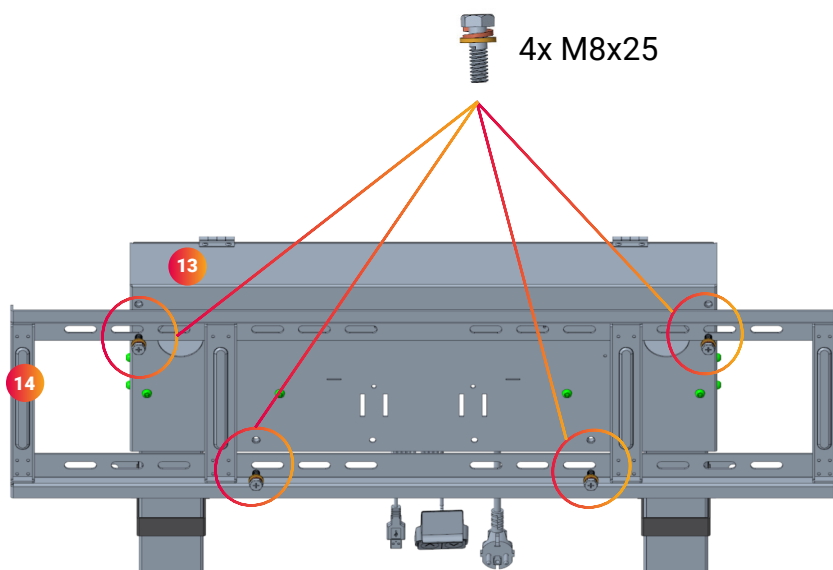

**You have now finished installing the stand onto the wall.**

# INSTALL OF THE MOBILE BASE

## Step 1: Install the base

Make sure to screw all the elements of the base together tightly with their respective screws. Refer to the drawing down below to see which screws go where. Please keep the caster in the braked state before you start installing the base.

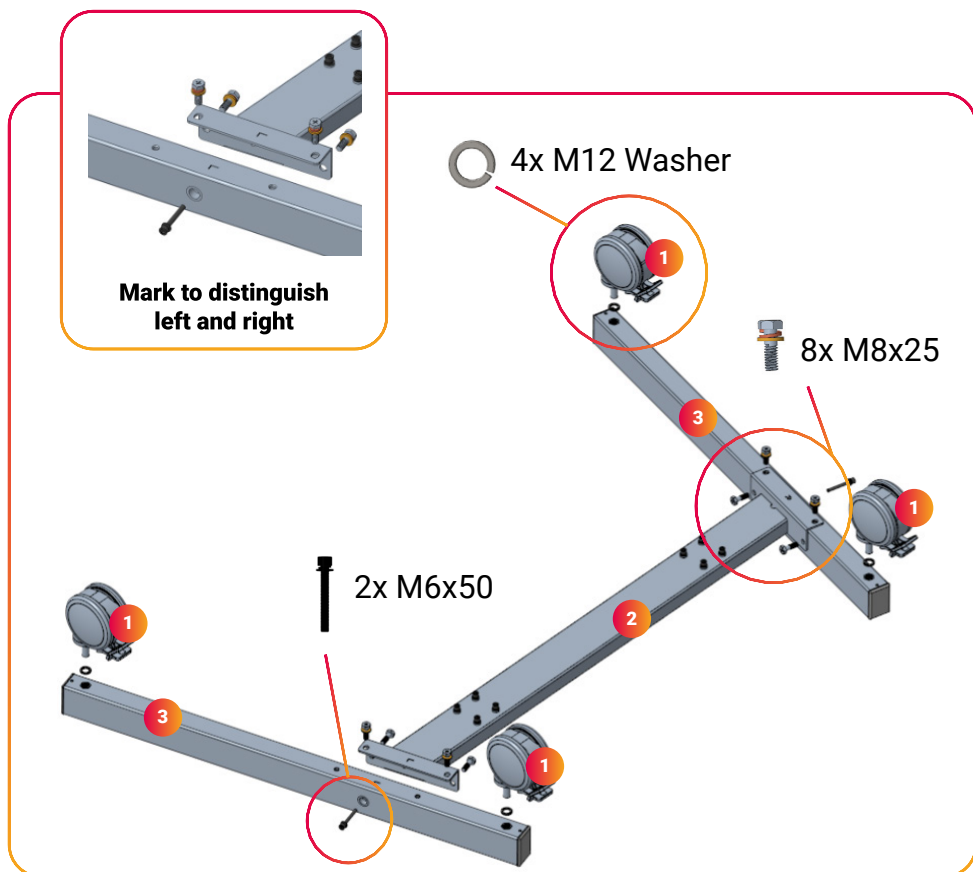

## INSTALL OF THE MOBILE BASE

### Step 2: Install the mobile base onto the stand.

Unscrew the bar from the base of the stand and replace it by installing the mobile base with wheels. Secure them tightly with the 8 screws you unscrewed from the bar.

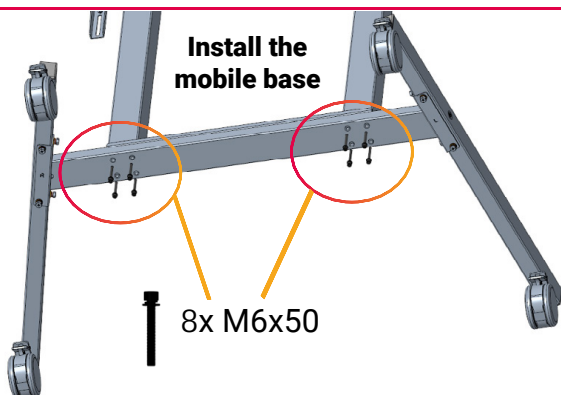

You have now finished installing the mobile part onto the base



# INSTALLATION OF THE LAPTOP TRAY \*

## Step 1: Attach the hanging bars onto the stand

Attach part 6 and 7, which are the hanging bars, onto the stand with the M6x12 and the M4x6 screws. Do not tighten these screws yet.

\* This is an optional accessory.

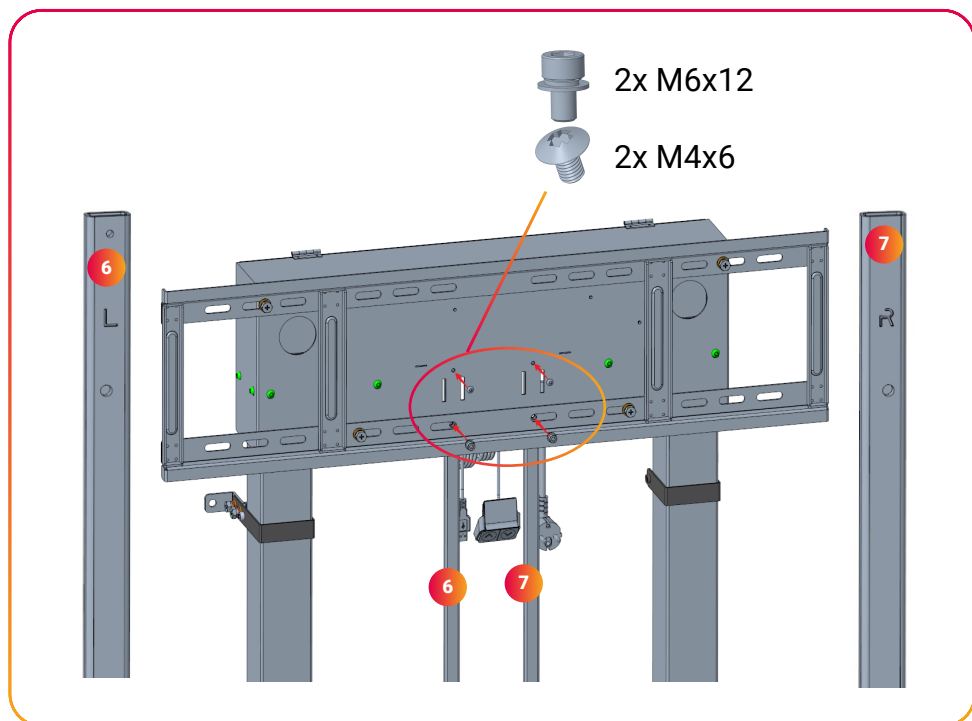

# INSTALLATION OF THE LAPTOP TRAY \*

## Step 2: Assemble the tray

Attach parts 8 and 9 onto the tray with the M4x6 bolts.  
Do not tighten these screws yet.

\* This is an optional accessory.

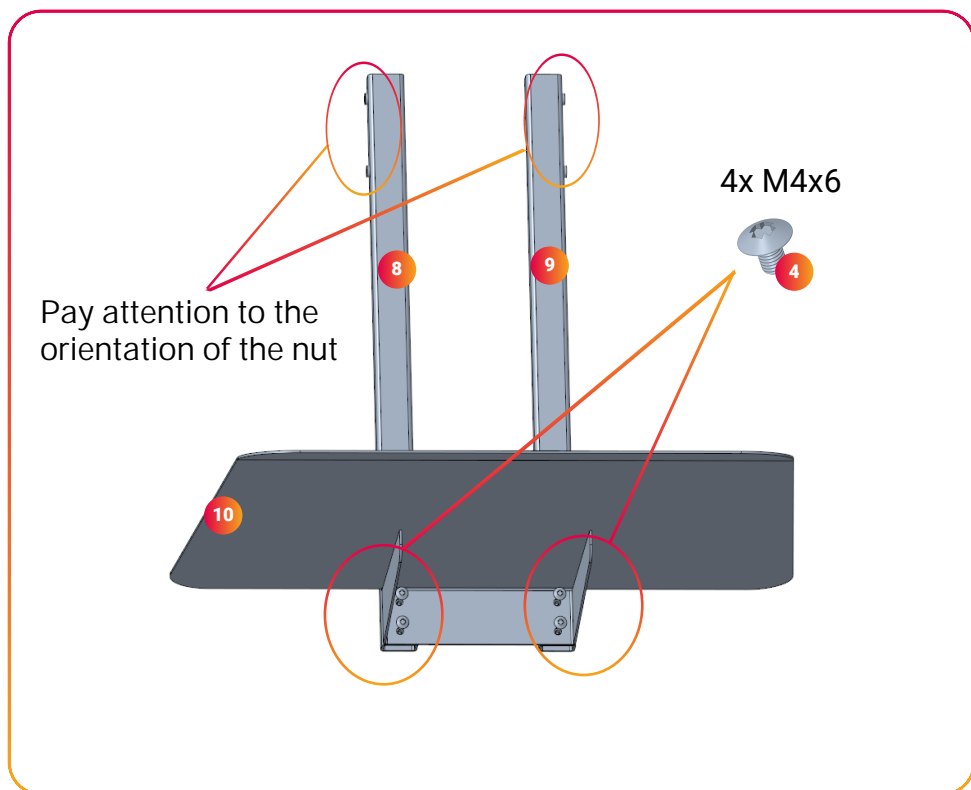

## INSTALLATION OF THE LAPTOP TRAY \*

### Step 3: Attach the tray on to the hanging bars

You can now go ahead and attach the tray onto the hanging bars with M4x6 screws by sliding the tray bars over the hanging bars.

Please adjust the tray to the appropriate position before tightening the screws. During the adjustment process, please ensure that the four screws in this step press against Part 6 and Part 7 respectively. Afterwards, you can go ahead and tighten all of the screws you installed in this step and the previous steps.

\* This is an optional accessory.

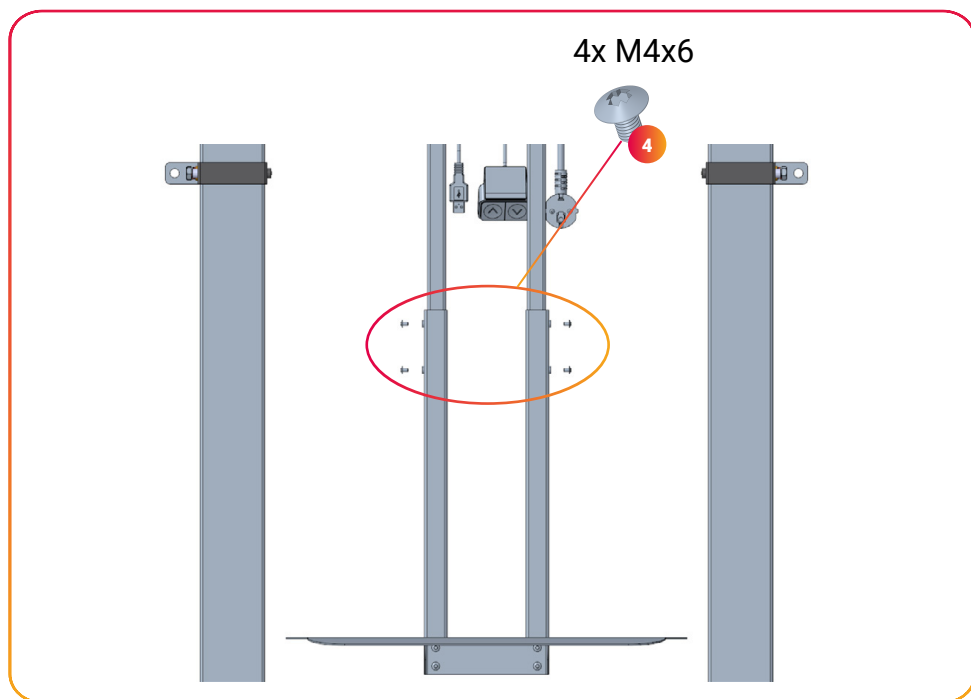

**You have now finished installing the laptop tray onto the stand**

# INSTALL THE SCREEN ONTO THE MOUNT

## Step 1: screw the brackets onto the interactive flat panel

Attach part 11 onto the interactive flat panel by screwing four M8x25 screws into place. Make sure you tighten the screws well.

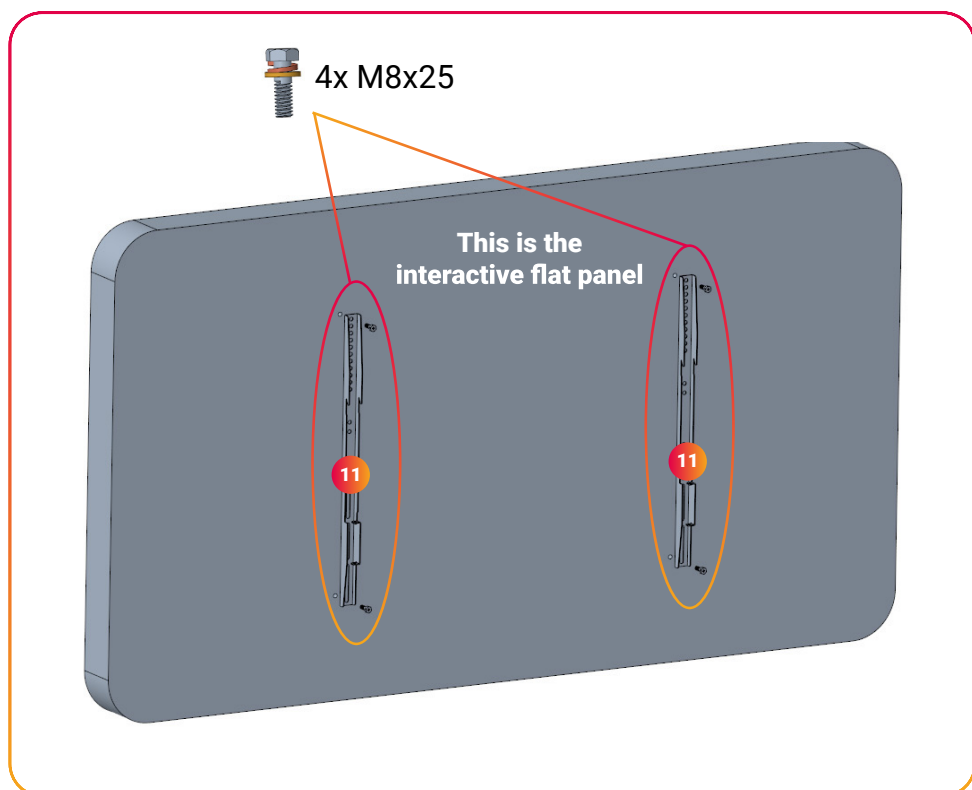

## INSTALL THE SCREEN ONTO THE MOUNT

### Step 2: Install the screen onto the stand of the Lift 4.

You can now install the interactive flat panel (IFP) onto the stand. Make sure to tightly secure all of the screws and the safety bolts.

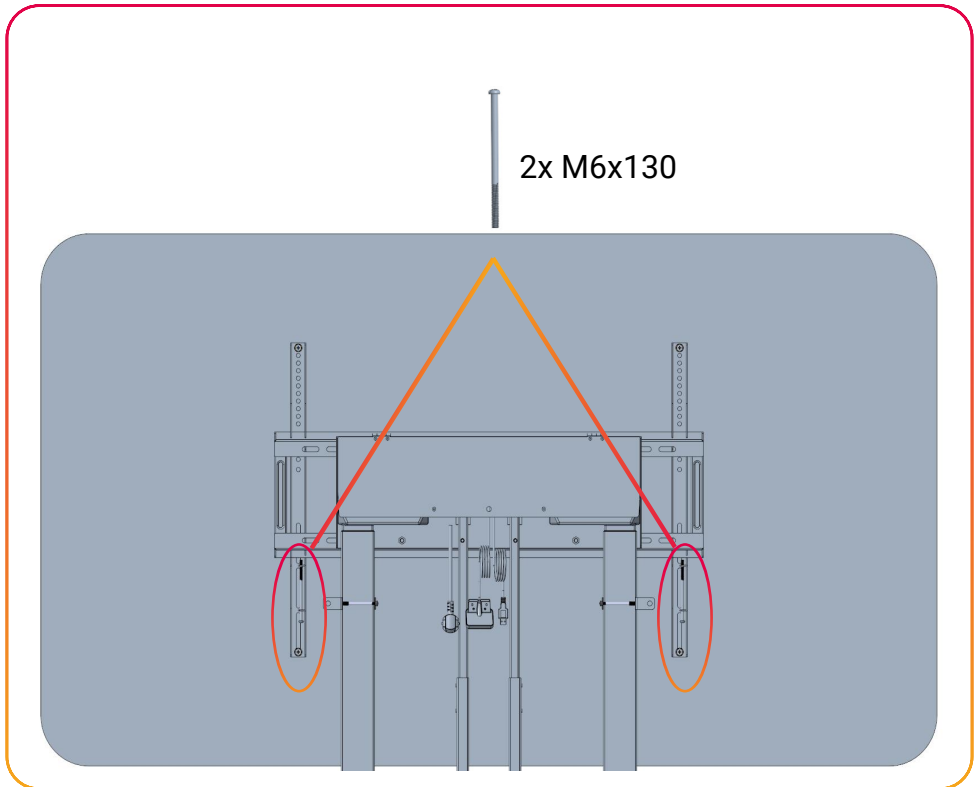

**You have now finished installing the IFP onto the stand**

# OPERATING INSTRUCTIONS

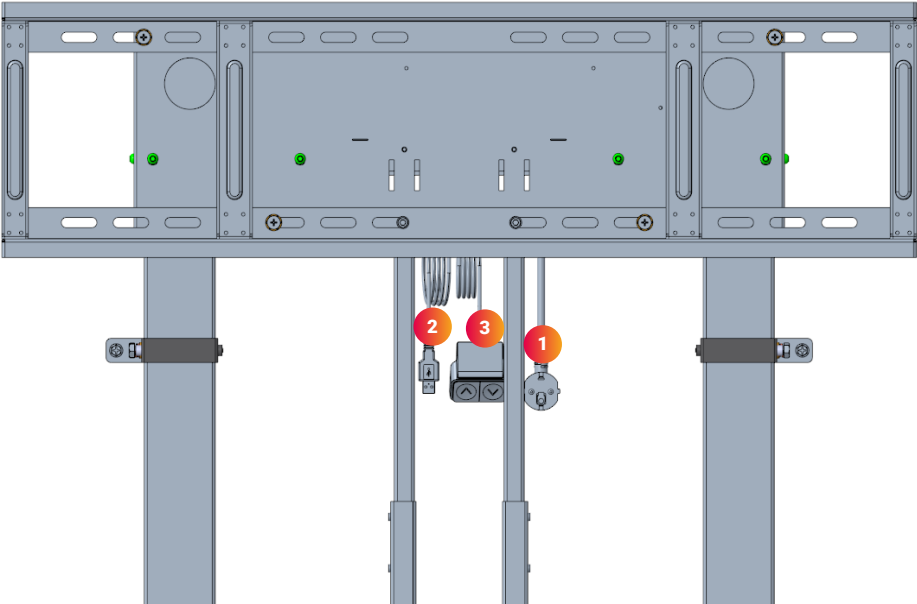

NR.	NAME	EXPLANATION
1	Power cord	Plug the power cord into the socket
2	USB Cable	Connect the USB cable to the interactive flat panel
3	Hand control	Fix the hand controller at the bottom of the screen

# HAND CONTROL

## Warning

When using the stand for the first time, press and hold the down button on the remote control for 10 seconds until the lifting system is reset and you can hear a beep sound.

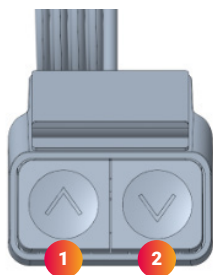

NR.	NAME	EXPLANATION
1	Up	Make the i3CONNECT Lift 4 go up
2	Down	Make the i3CONNECT Lift 4 go down

# ON-SCREEN CONTROL OF THE LIFT 4

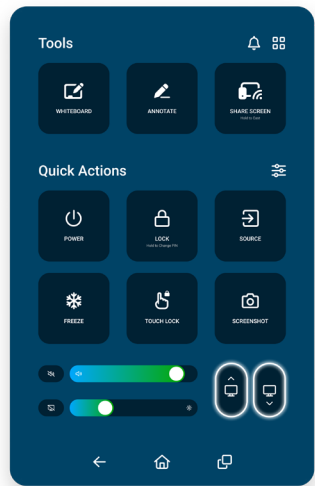

The i3CONNECT Lift 4 can be controlled via the i3CONNECT Studio side menu. To access the menu:

1. Insert the USB of the Lift 4 into your i3CONNECT touchscreen
2. Open the side menu in i3CONNECT Studio. There you will find up and down buttons at the bottom right corner.
3. Press the up and down buttons that are highlighted in the image on the left to move the Lift 4 up and down.

